

目录

- 1、AUEC 2A4B-BUS产品接线图
- 2、AUEC 6A0B-BUS产品接线图
- 3、AUEC 8A0B产品接线图
- 4、AUEC 0A8B产品接线图
- 5、AUEC 4A4B产品接线图
- 6、AUPN 2A4B-BUS产品接线图
- 7、AUPN 6A0B-BUS产品接线图
- 8、AUPN 8A0B产品接线图
- 9、AUPN 0A8B产品接线图
- 10、AUPN 4A4B产品接线图
- 11、AUCB 2A4B-BUS产品接线图
- 12、AUCB 6A0B-BUS产品接线图
- 13、AUCB 8A0B产品接线图
- 14、AUEI 2A4B-BUS产品接线图
- 15、AUEI 6A0B-BUS产品接线图
- 16、AUEI 8A0B产品接线图
- 17、AUCP 8A0B产品接线图

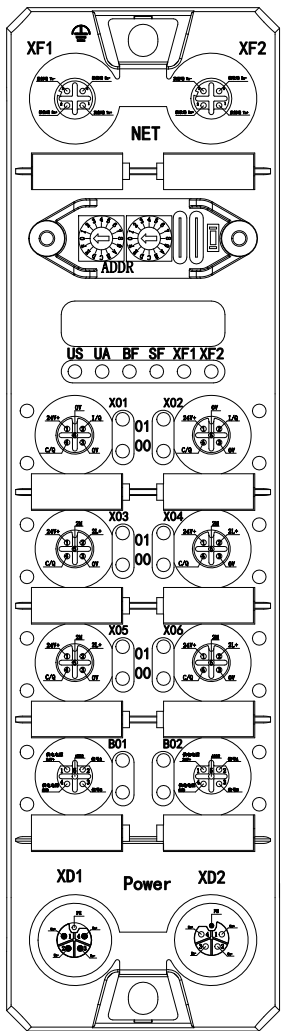

X01、X02

IO-Link Class A接线图

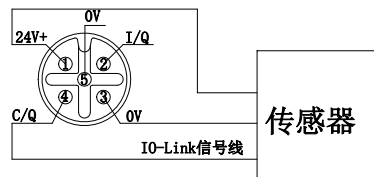

X03~X06

IO-Link Class B接线图

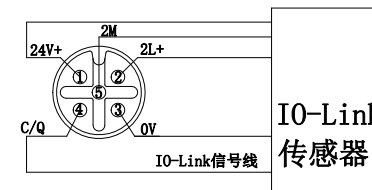

当Pin4和Pin2都配置为PNP输入
(两线制)

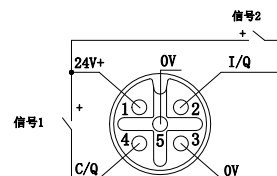

当Pin4和Pin2都配置为PNP输入
(三线制)

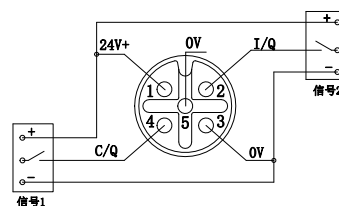

当Pin4配置为PNP输入
(两线制)

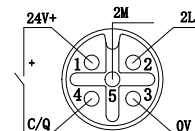

当Pin4配置为PNP输入
(三线制)

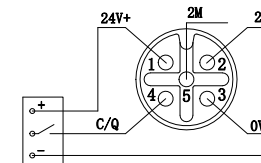

当Pin4配置为PNP输出

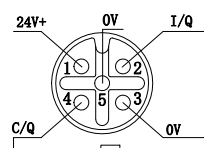

当Pin4配置为NPN输出

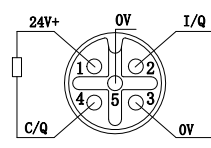

当Pin4配置为PNP输出

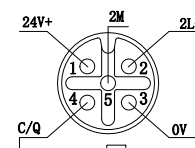

当Pin4配置为NPN输出

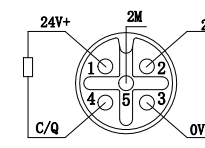

电源输入XD1
L-CODE 接线图

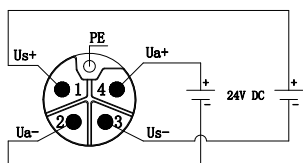

AUEC 2A4B-BUS 产品接线图

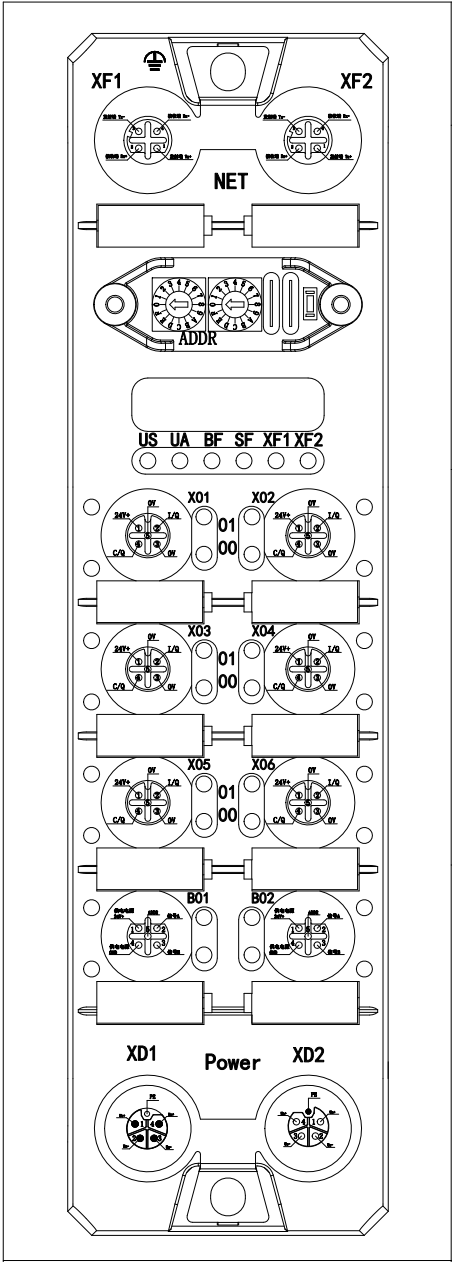

X01-X06

I0-Link Class A接线图

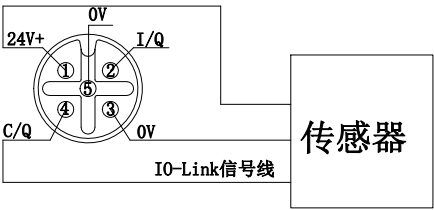

当Pin4和Pin2都配置为PNP输入
(两线制)

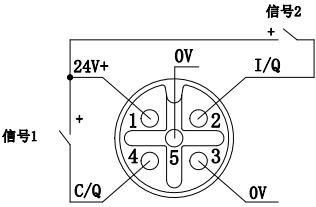

当Pin4和Pin2都配置为PNP输入
(三线制)

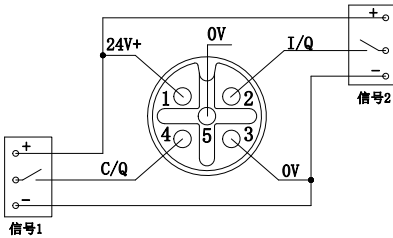

当Pin4配置为PNP输出

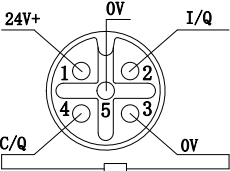

当Pin4配置为NPN输出

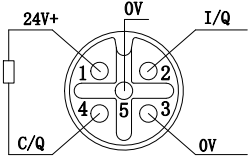

电源输入XD1
L-CODE 接线图

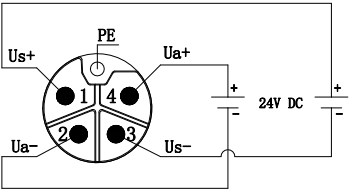

AUEC 6A0B-BUS 产品接线图

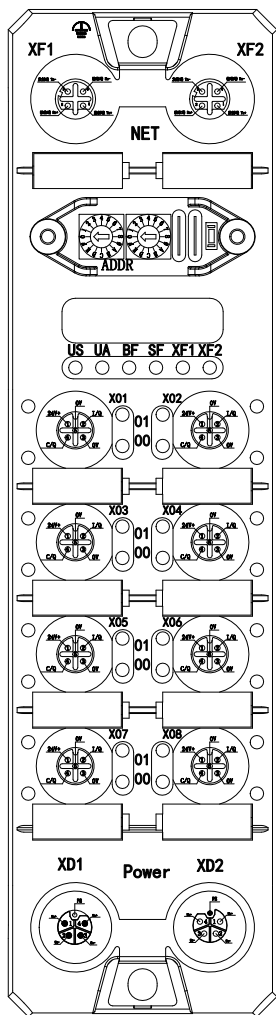

X01~X08配置为Class A

IO-Link Class A接线图

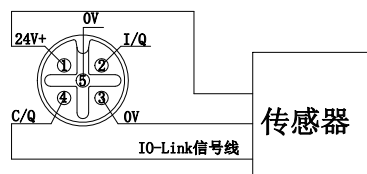

当Pin4和Pin2都配置为PNP输入
(两线制)

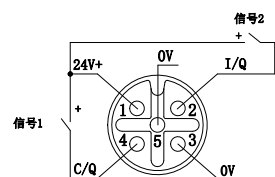

当Pin4和Pin2都配置为PNP输入
(三线制)

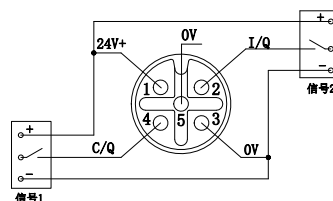

当Pin4配置为PNP输出

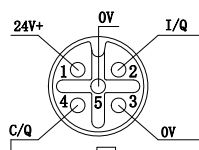

当Pin4配置为NPN输出

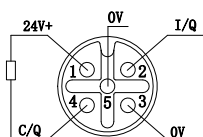

X01~X08配置为Class B

IO-Link Class B接线图

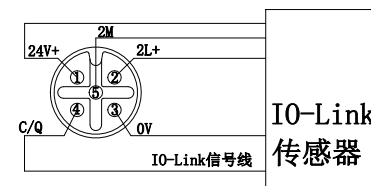

当Pin4配置为PNP输入
(两线制)

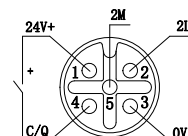

当Pin4配置为PNP输入
(三线制)

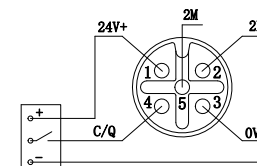

当Pin4配置为PNP输出

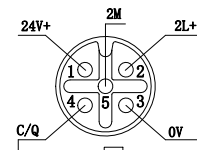

当Pin4配置为NPN输出

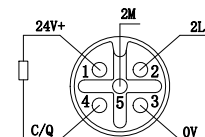

电源输入XD1
L-CODE 接线图

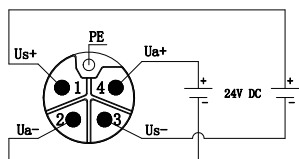

AUEC 8A0B 产品接线图

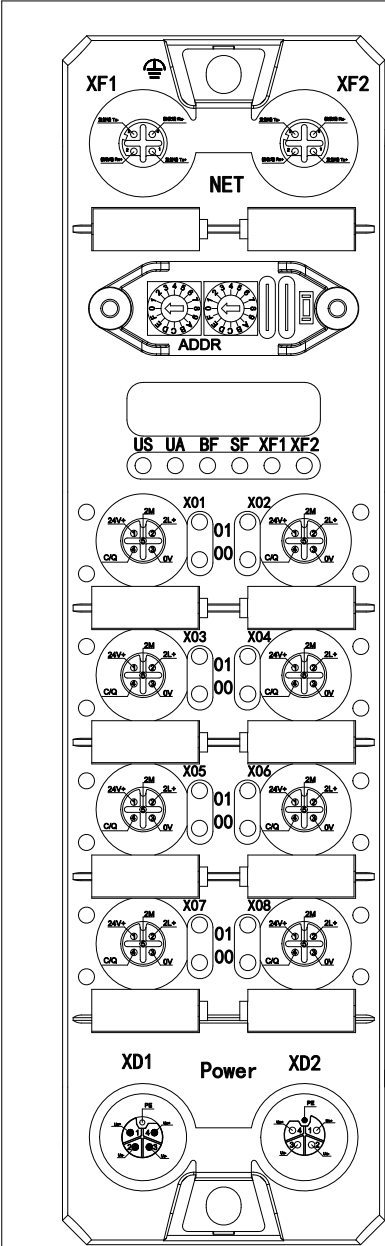

X01~X08

IO-Link Class B接线图

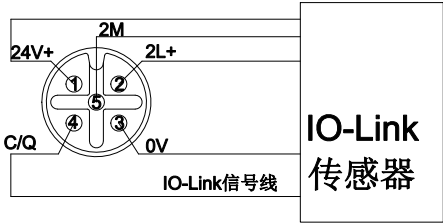

当Pin4配置为PNP输入
(两线制)

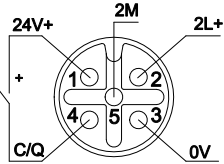

当Pin4配置为PNP输入
(三线制)

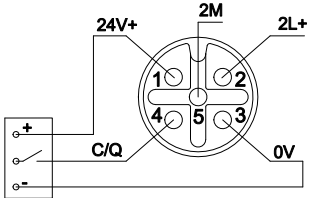

当Pin4配置为PNP输出

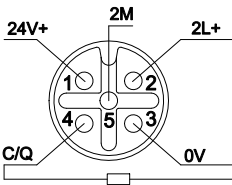

当Pin4配置为NPN输出

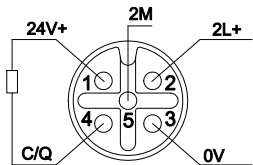

电源输入XD1 L-CODE 接线图

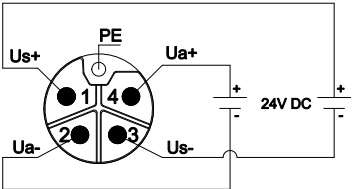

AUEC 0A8B 产品接线图

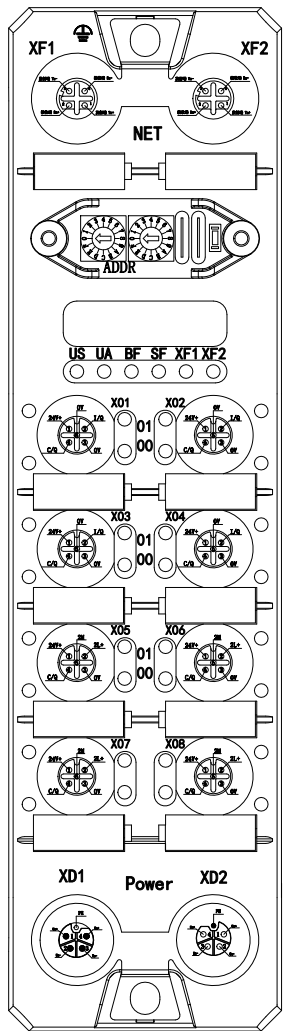

X01~X04

IO-Link Class A接线图

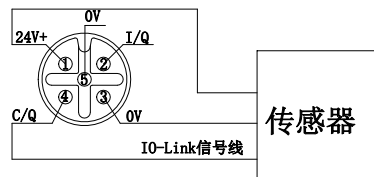

X05~X08

IO-Link Class B接线图

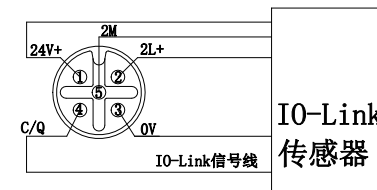

当Pin4和Pin2都配置为PNP输入
(两线制)

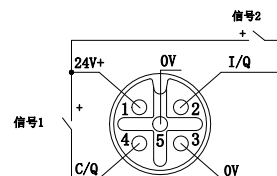

当Pin4和Pin2都配置为PNP输入
(三线制)

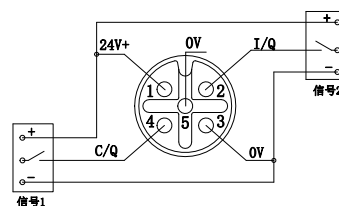

当Pin4配置为PNP输入
(两线制)

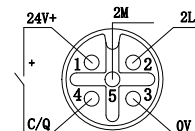

当Pin4配置为PNP输入
(三线制)

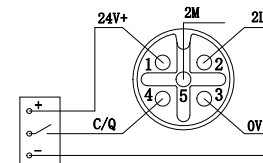

当Pin4配置为PNP输出

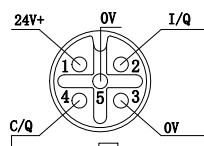

当Pin4配置为NPN输出

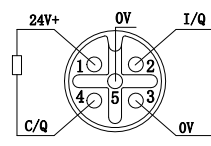

当Pin4配置为PNP输出

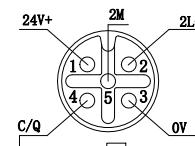

当Pin4配置为NPN输出

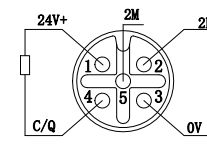

电源输入XD1
L-CODE 接线图

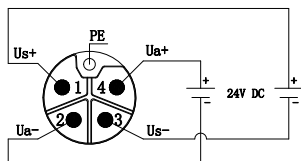

AUEC 4A4B 产品接线图

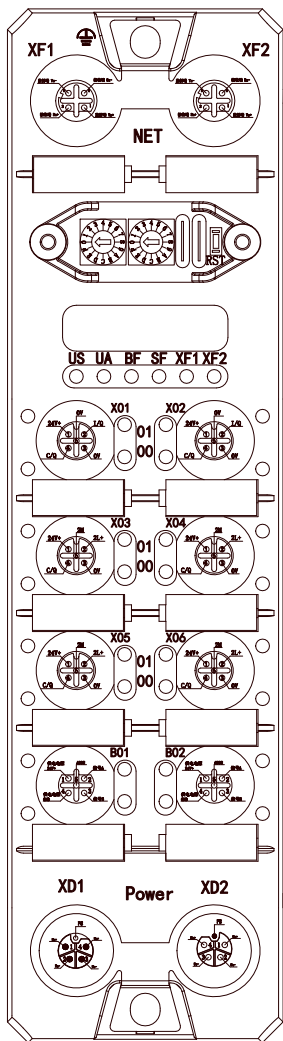

电源输入XD1
L-CODE 接线图

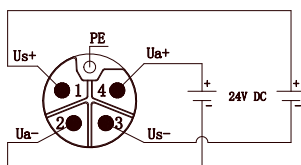

X01、X02

I0-Link Class A接线图

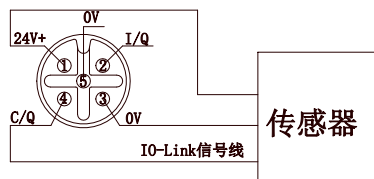

当Pin4和Pin2都配置为PNP输入
(两线制)

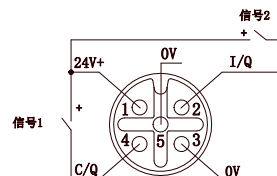

当Pin4和Pin2都配置为PNP输入
(三线制)

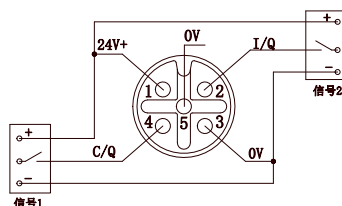

当Pin4配置为PNP输出

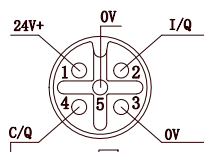

当Pin4配置为NPN输出

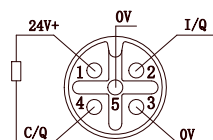

X03~X06

I0-Link Class B接线图

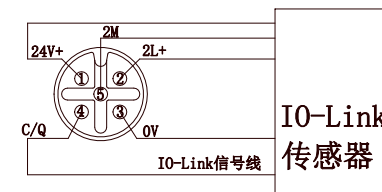

当Pin4配置为PNP输入
(两线制)

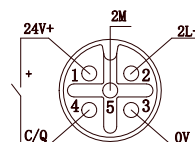

当Pin4配置为PNP输入
(三线制)

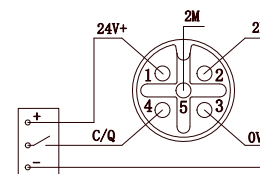

当Pin4配置为PNP输出

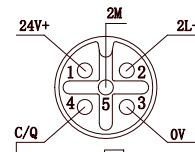

当Pin4配置为NPN输出

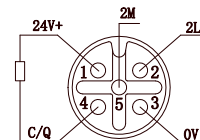

AUPN 2A4B-BUS产品接线图

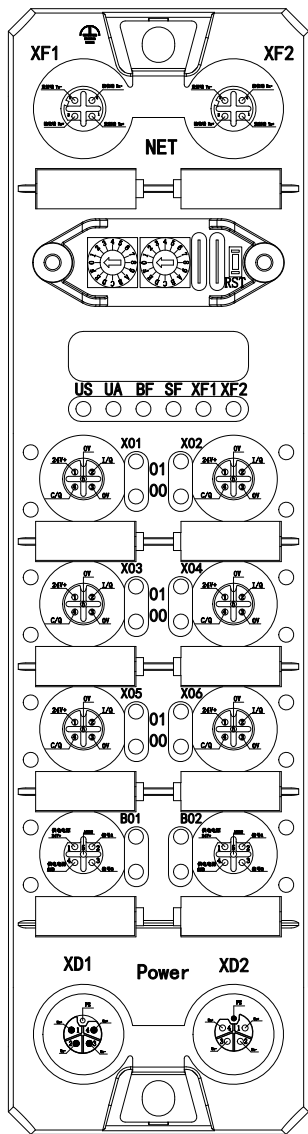

X01-X06

IO-Link Class A接线图

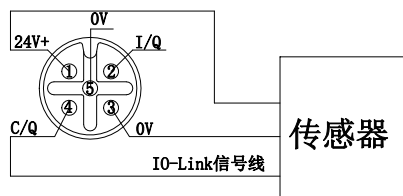

当Pin4和Pin2都配置为PNP输入 (两线制)

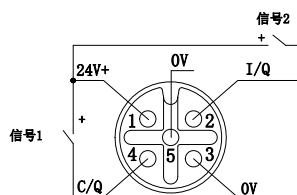

当Pin4和Pin2都配置为PNP输入 (三线制)

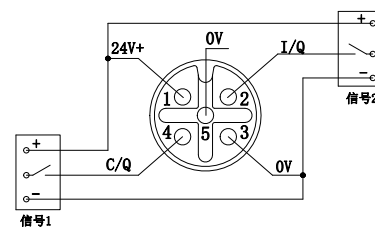

当Pin4配置为PNP输出

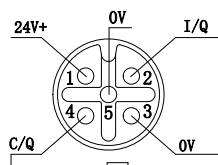

当Pin4配置为NPN输出

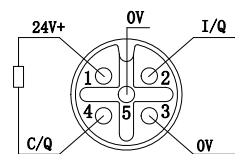

电源输入XD1 L-CODE 接线图

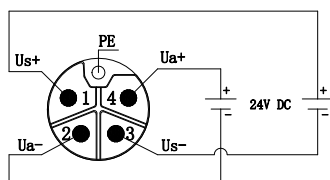

AUPN 6A0B-BUS产品接线图

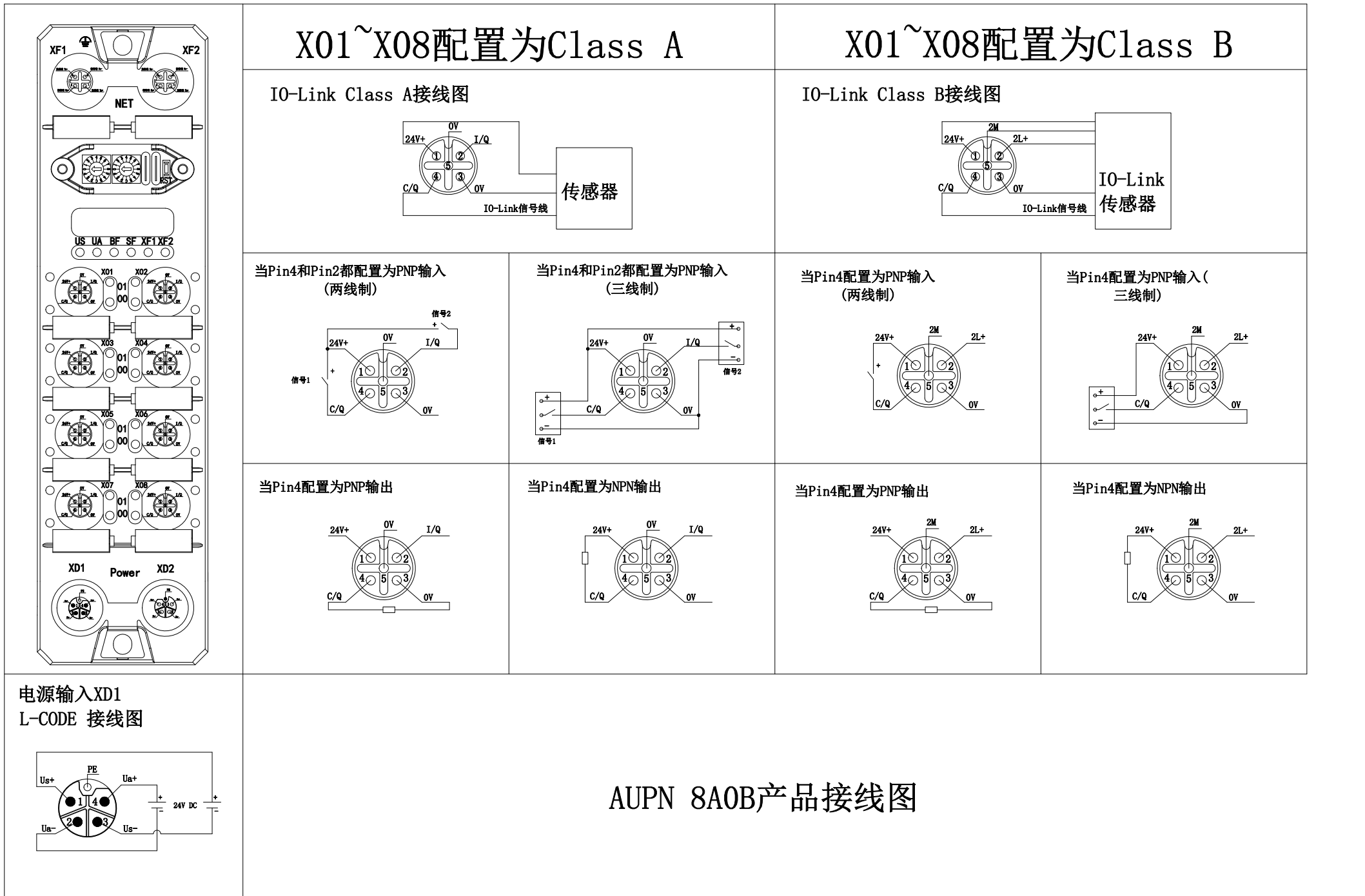

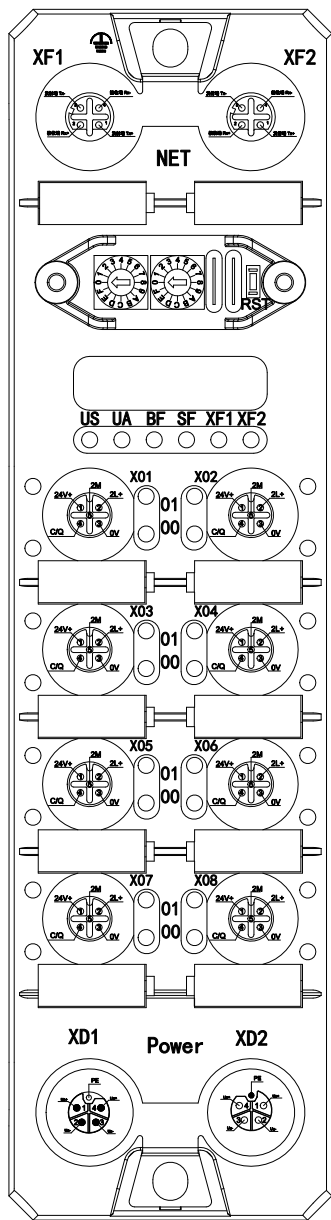

X01~X08

IO-Link Class B接线图

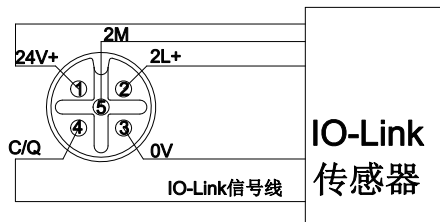

当Pin4配置为PNP输入 (两线制)

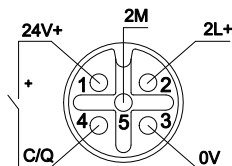

当Pin4配置为PNP输入 (三线制)

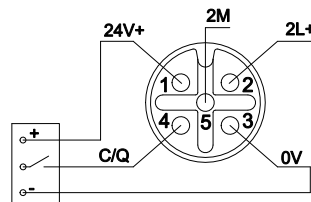

当Pin4配置为PNP输出

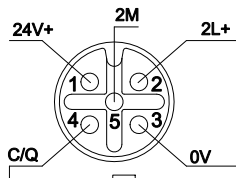

当Pin4配置为NPN输出

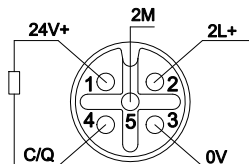

电源输入XD1 L-CODE 接线图

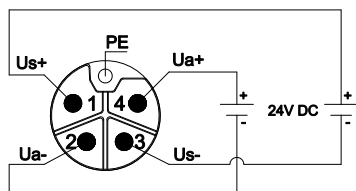

AUPN 0A8B产品接线图

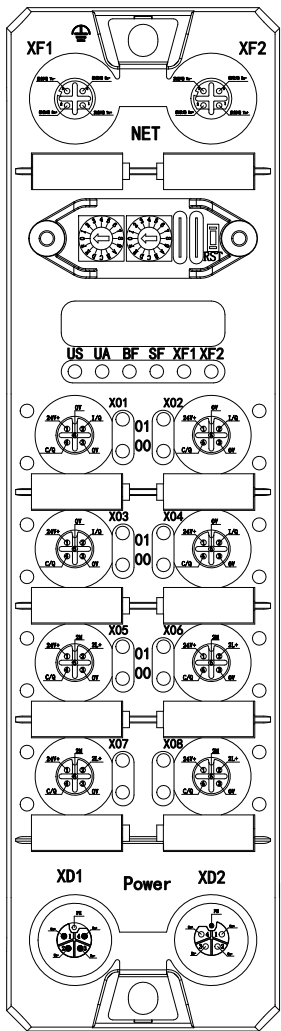

X01~X04

IO-Link Class A接线图

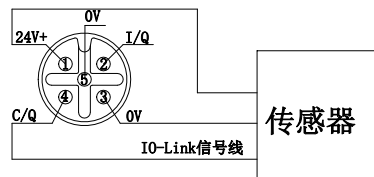

X05~X08

IO-Link Class B接线图

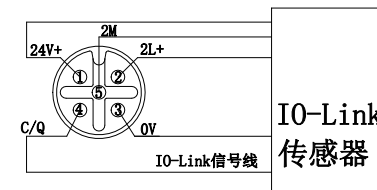

当Pin4和Pin2都配置为PNP输入
(两线制)

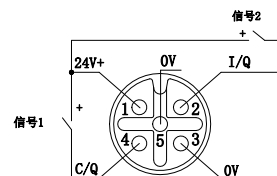

当Pin4和Pin2都配置为PNP输入
(三线制)

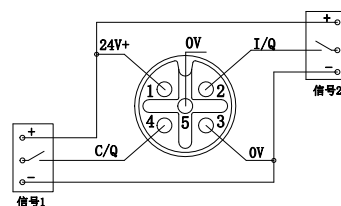

当Pin4配置为PNP输入
(两线制)

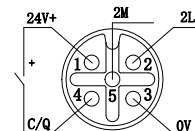

当Pin4配置为PNP输入
(三线制)

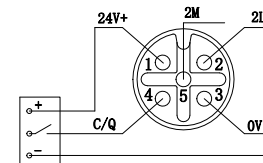

当Pin4配置为PNP输出

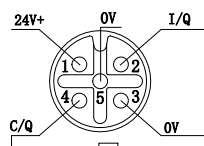

当Pin4配置为NPN输出

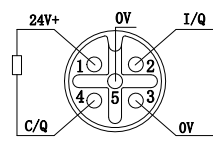

当Pin4配置为PNP输出

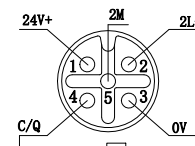

当Pin4配置为NPN输出

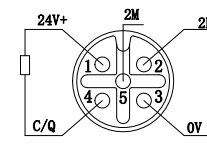

电源输入XD1
L-CODE 接线图

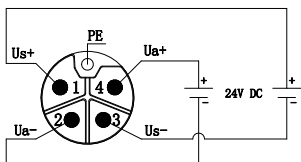

AUPN 4A4B 产品接线图

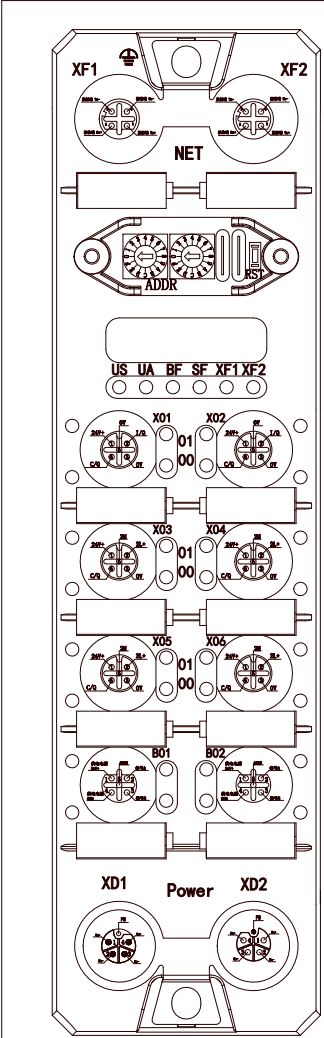

电源输入XD1
L-CODE 接线图

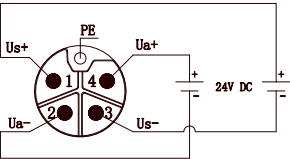

X01、X02

IO-Link Class A接线图

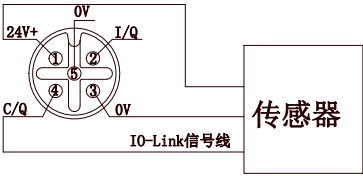

当Pin4和Pin2都配置为PNP输入
(两线制)

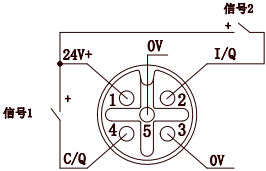

当Pin4和Pin2都配置为PNP输入
(三线制)

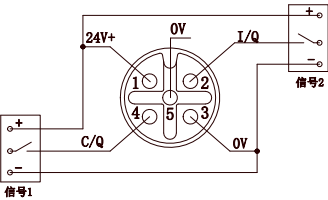

当Pin4配置为PNP输出

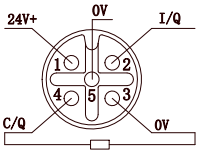

当Pin4配置为NPN输出

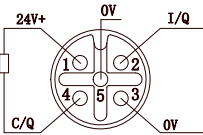

X03~X06

IO-Link Class B接线图

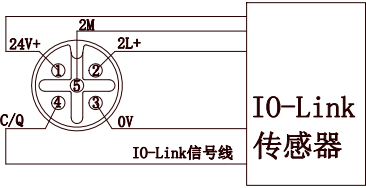

当Pin4配置为PNP输入
(两线制)

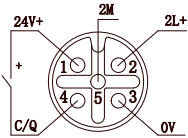

当Pin4配置为PNP输入
(三线制)

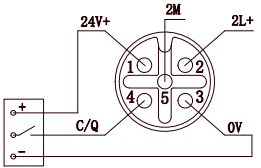

当Pin4配置为PNP输出

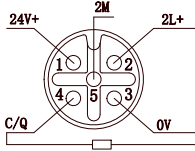

当Pin4配置为NPN输出

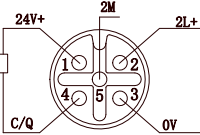

AUCB 2A4B-BUS 产品接线图

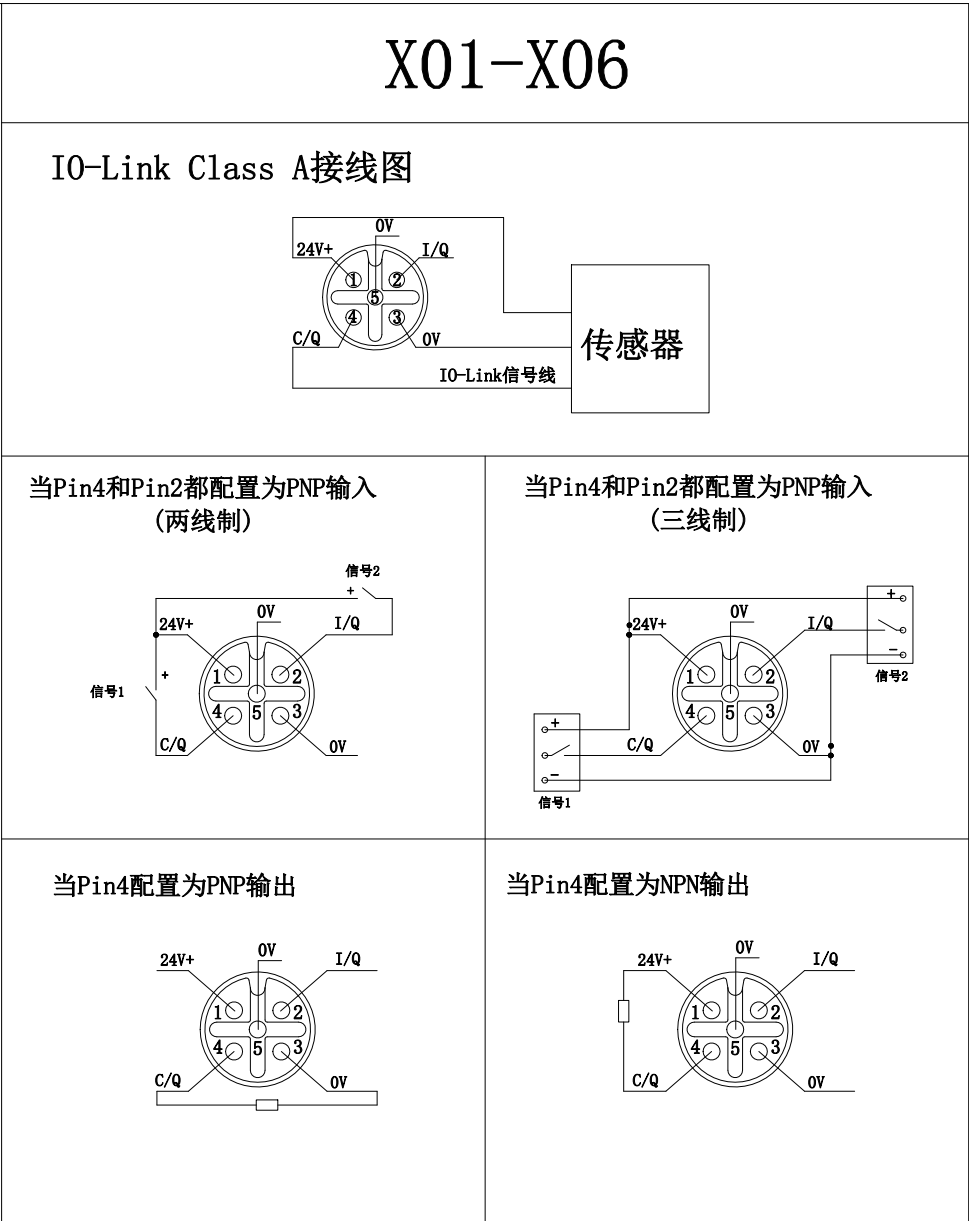
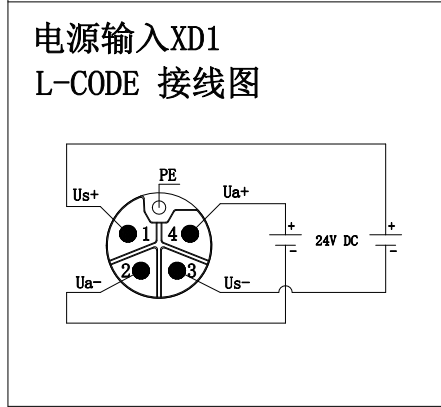
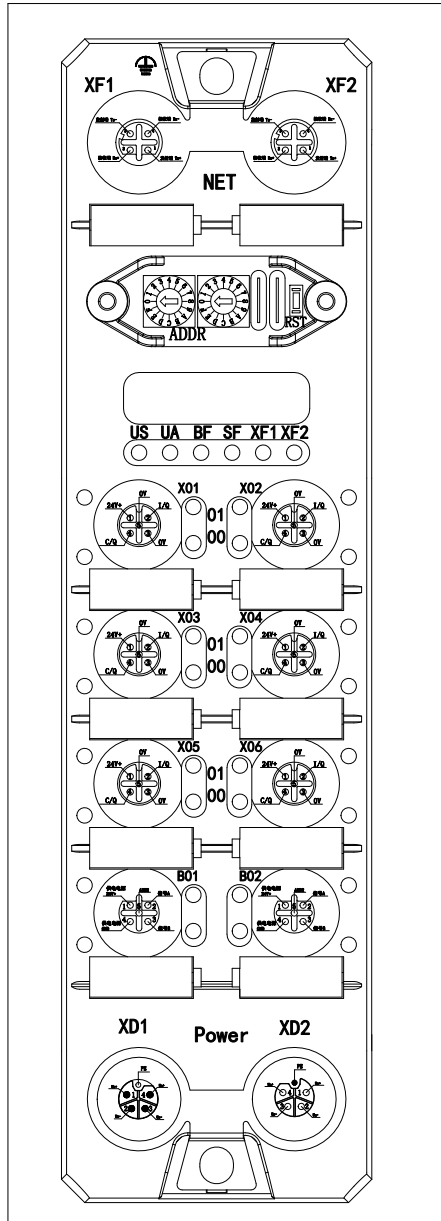

AUCB 6A0B-BUS 产品接线图

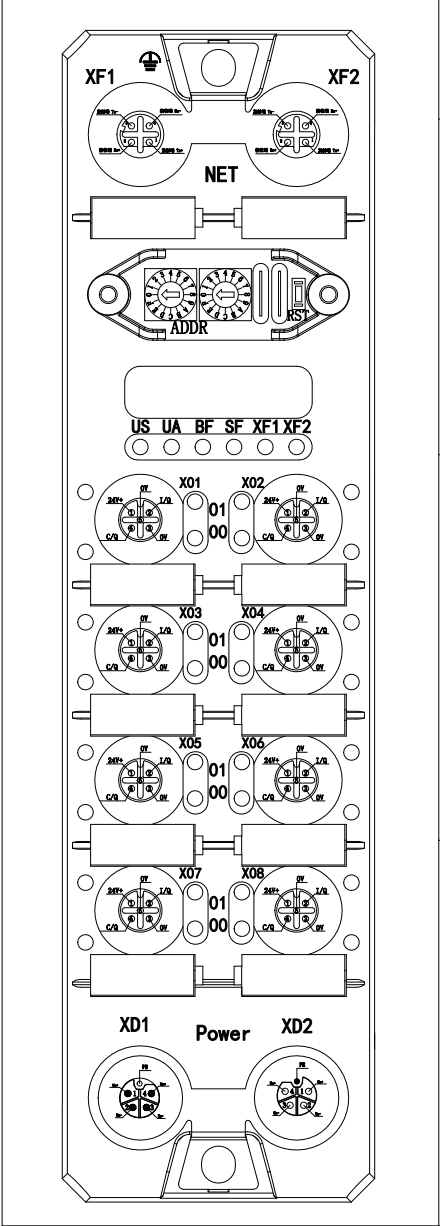

X01-X08

IO-Link Class A接线图

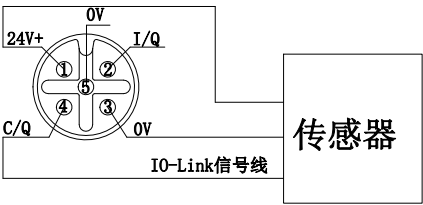

当Pin4和Pin2都配置为PNP输入
(两线制)

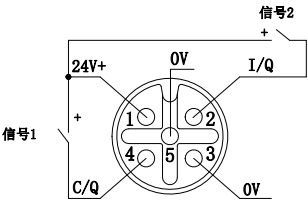

当Pin4和Pin2都配置为PNP输入
(三线制)

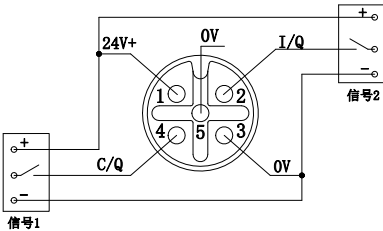

当Pin4配置为PNP输出

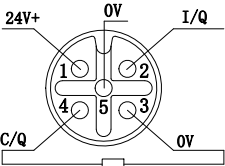

当Pin4配置为NPN输出

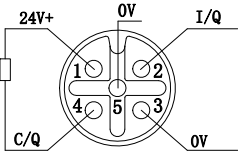

电源输入XD1
L-CODE 接线图

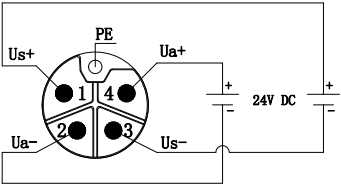

AUCB 8A0B 产品接线图

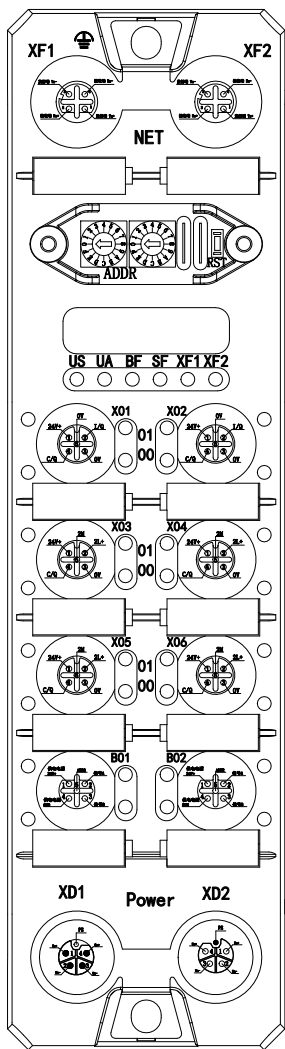

电源输入XD1
L-CODE 接线图

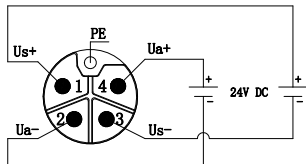

X01、X02

I0-Link Class A接线图

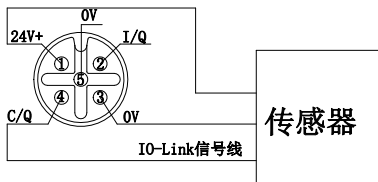

当Pin4和Pin2都配置为PNP输入
(两线制)

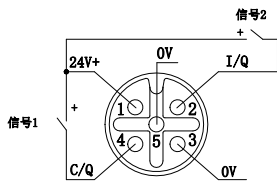

当Pin4和Pin2都配置为PNP输入
(三线制)

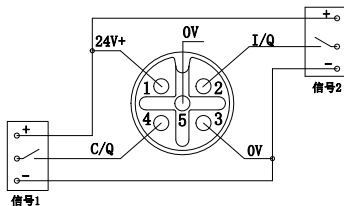

当Pin4配置为PNP输出

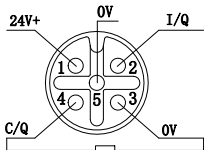

当Pin4配置为NPN输出

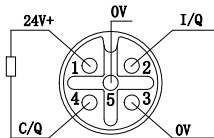

X03~X06

I0-Link Class B接线图

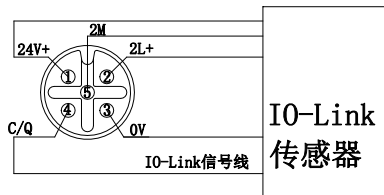

当Pin4配置为PNP输入
(两线制)

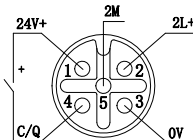

当Pin4配置为PNP输入
(三线制)

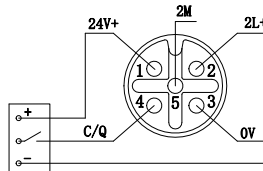

当Pin4配置为PNP输出

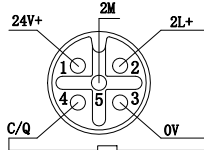

当Pin4配置为NPN输出

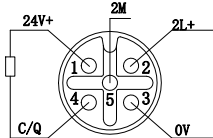

AUEI 2A4B-BUS 产品接线图

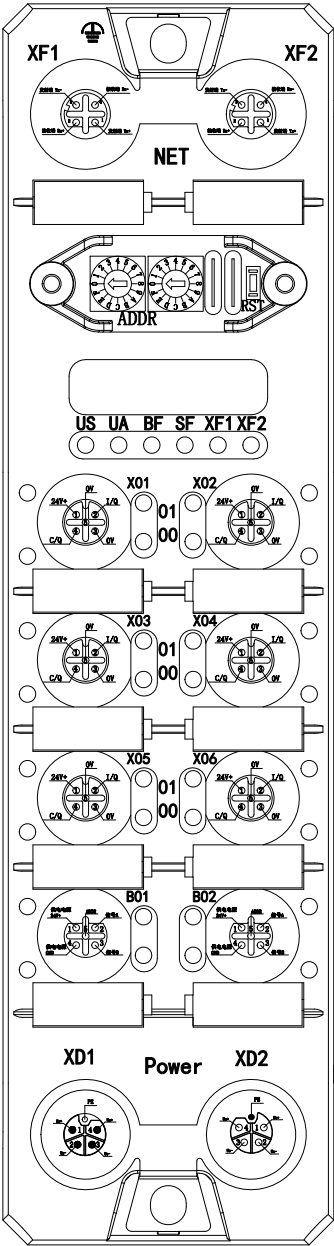

X01-X06

IO-Link Class A接线图

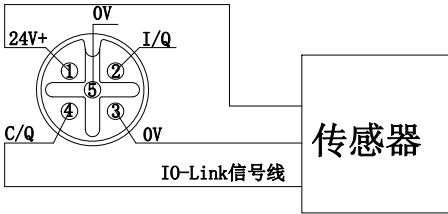

当Pin4和Pin2都配置为PNP输入
(两线制)

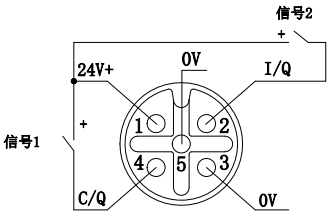

当Pin4和Pin2都配置为PNP输入
(三线制)

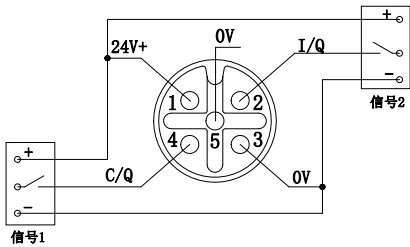

当Pin4配置为PNP输出

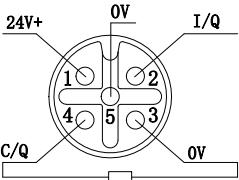

当Pin4配置为NPN输出

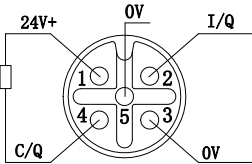

电源输入XD1
L-CODE 接线图

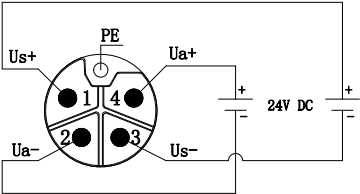

AUEI 6A0B-BUS 产品接线图

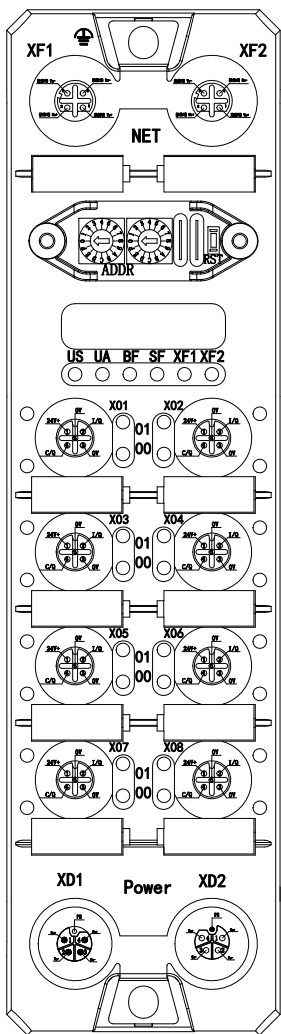

电源输入XD1
L-CODE 接线图

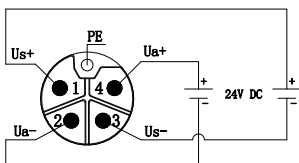

X01~X08配置为Class A

I0-Link Class A接线图

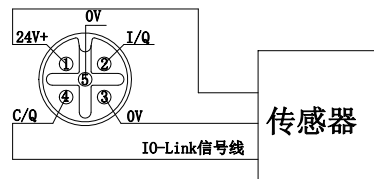

当Pin4和Pin2都配置为PNP输入
(两线制)

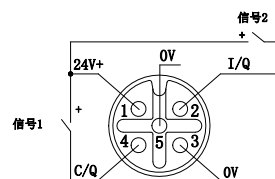

当Pin4和Pin2都配置为PNP输入
(三线制)

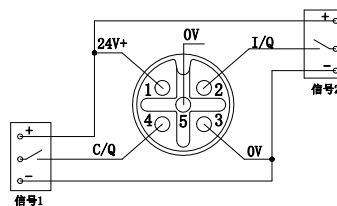

当Pin4配置为PNP输出

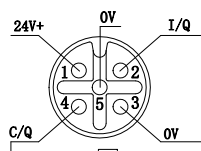

当Pin4配置为NPN输出

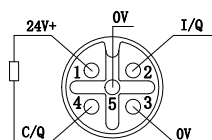

X01~X08配置为Class B

I0-Link Class B接线图

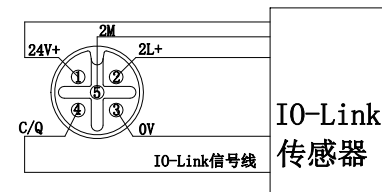

当Pin4配置为PNP输入
(两线制)

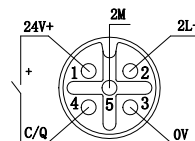

当Pin4配置为PNP输入
(三线制)

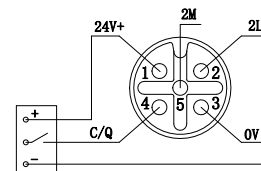

当Pin4配置为PNP输出

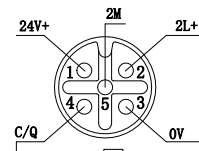

当Pin4配置为NPN输出

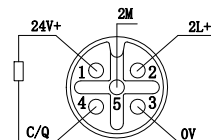

AUEI 8A0B产品接线图

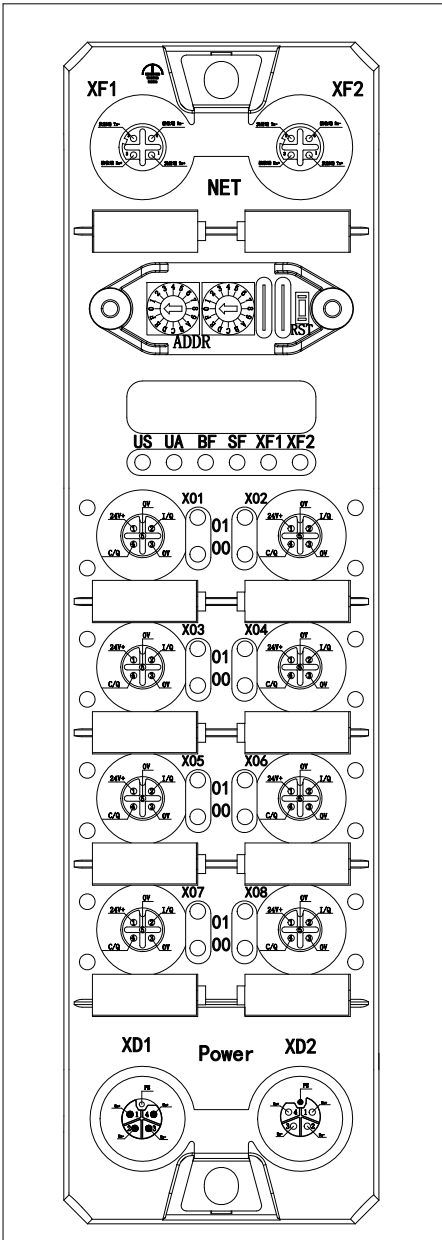

X01-X08

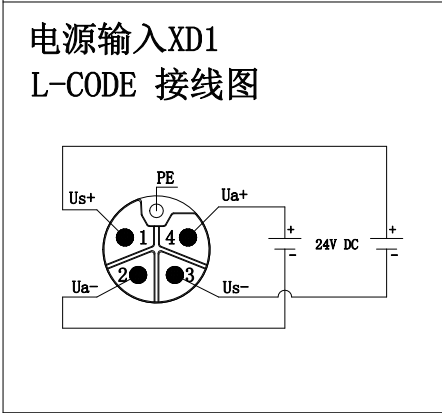
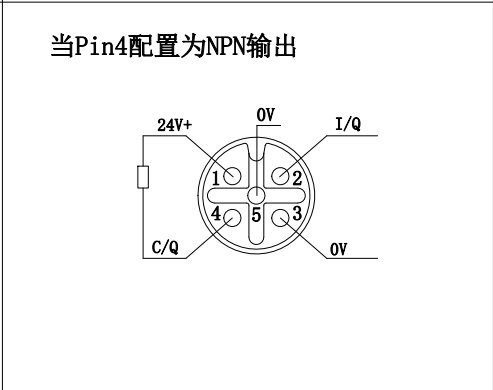
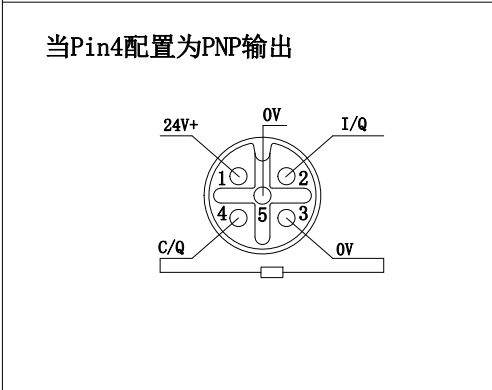
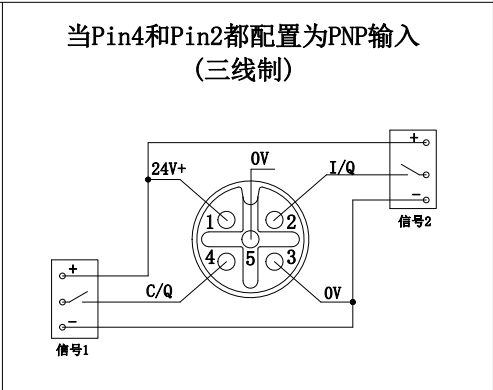
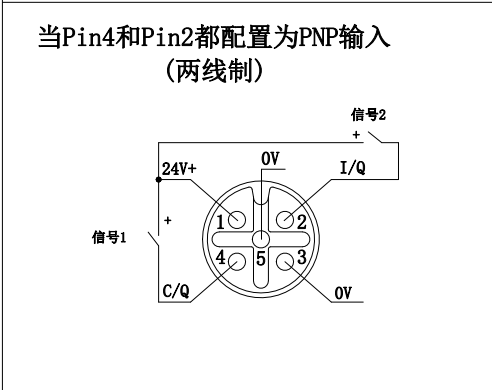
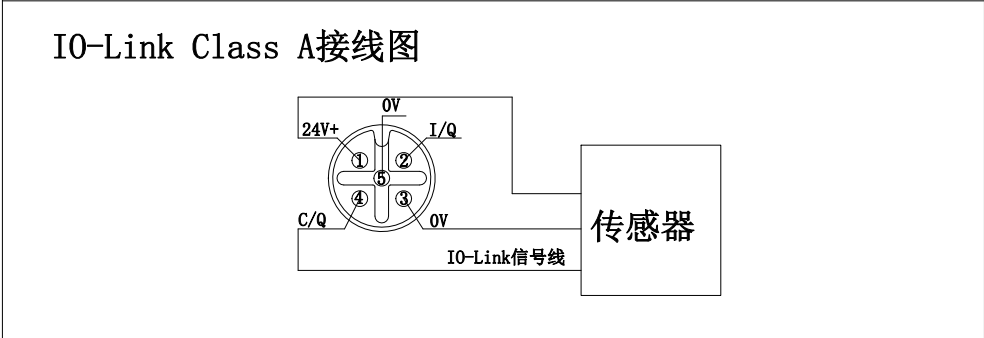

AUCP 8A0B产品接线图